

## TO-247

### DIMENSIONS in millimeters and inches

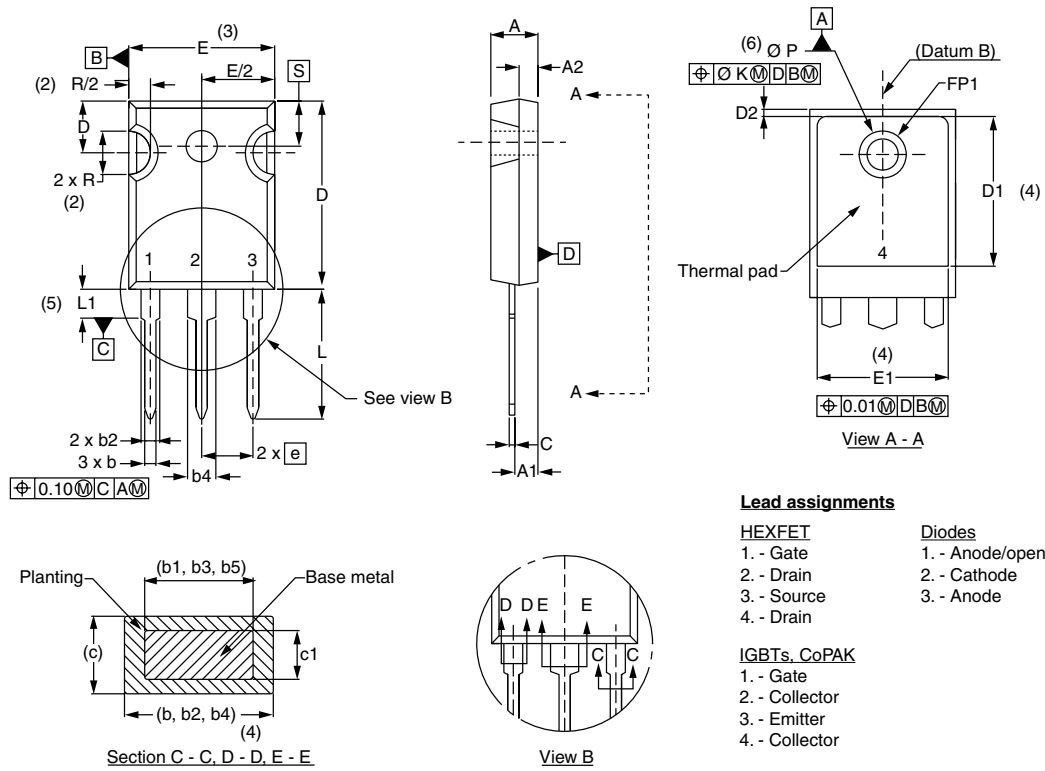

| SYMBOL | MILLIMETERS |       | INCHES |       | NOTES |
|--------|-------------|-------|--------|-------|-------|
|        | MIN.        | MAX.  | MIN.   | MAX.  |       |
| A      | 4.65        | 5.31  | 0.183  | 0.209 |       |
| A1     | 2.21        | 2.59  | 0.087  | 0.102 |       |
| A2     | 1.50        | 2.49  | 0.059  | 0.098 |       |
| b      | 0.99        | 1.40  | 0.039  | 0.055 |       |
| b1     | 0.99        | 1.35  | 0.039  | 0.053 |       |
| b2     | 1.65        | 2.39  | 0.065  | 0.094 |       |
| b3     | 1.65        | 2.37  | 0.065  | 0.094 |       |
| b4     | 2.59        | 3.43  | 0.102  | 0.135 |       |
| b5     | 2.59        | 3.38  | 0.102  | 0.133 |       |
| c      | 0.38        | 0.86  | 0.015  | 0.034 |       |
| c1     | 0.38        | 0.76  | 0.015  | 0.030 |       |
| D      | 19.71       | 20.70 | 0.776  | 0.815 | 3     |
| D1     | 13.08       | -     | 0.515  | -     | 4     |

| SYMBOL | MILLIMETERS |       | INCHES    |       | NOTES |
|--------|-------------|-------|-----------|-------|-------|
|        | MIN.        | MAX.  | MIN.      | MAX.  |       |
| D2     | 0.51        | 1.30  | 0.020     | 0.051 |       |
| E      | 15.29       | 15.87 | 0.602     | 0.625 | 3     |
| E1     | 13.72       | -     | 0.540     | -     |       |
| e      | 5.46 BSC    |       | 0.215 BSC |       |       |
| FK     | 2.54        |       | 0.010     |       |       |
| L      | 14.20       | 16.10 | 0.559     | 0.634 |       |
| L1     | 3.71        | 4.29  | 0.146     | 0.169 |       |
| N      | 7.62 BSC    |       | 3         |       |       |
| FP     | 3.56        | 3.66  | 0.14      | 0.144 |       |
| FP1    | -           | 6.98  | -         | 0.275 |       |
| Q      | 5.31        | 5.69  | 0.209     | 0.224 |       |
| R      | 0.452       | 5.49  | 0.178     | 0.216 |       |
| S      | 5.51 BSC    |       | 0.217 BSC |       |       |

**Notes**

- (1) Dimensioning and tolerancing per ASME Y14.5M-1994
- (2) Contour of slot optional
- (3) Dimension D and E do not include mold flash. Mold flash shall not exceed 0.127 mm (0.005") per side. These dimensions are measured at the outermost extremes of the plastic body
- (4) Thermal pad contour optional with dimensions D1 and E1
- (5) Lead finish uncontrolled in L1
- (6) Ø P to have a maximum draft angle of 1.5 to the top of the part with a maximum hole diameter of 3.91 mm (0.154")
- (7) Outline conforms to JEDEC outline TO-247 with exception of dimension c